

ARCHITECTURAL SPECIFICATION:

WALL PADDING TO BE MODEL- WP-24LU AS MANUFACTURED BY AK ATHLETIC EQUIPMENT, INC. IN COLUMBUS, OH. SIZE TO BE 2' WIDE BY 2 1/2" DEEP BY 4' HIGH WITH 1" LIP ON TOP AND BOTTOM OF EACH PANEL. PADS TO BE CONSTRUCTED USING 2" THICK FOAM OF 5/8" POLYURETHANE AND 1 3/8" POLYETHYLENE CEMENTED TO 7/16" OSB. COVER MATERIAL TO BE _____ (COLOR) 14 OUNCE POLYESTER LAMINATED VINYL STAPLED TO BACKING EVERY TWO INCHES.

VINYL IS PUNCTURE AND TEAR RESISTANT WITH MILDEW, ROT AND FUNGICIDE COMBATING PROPERTIES. COLOR AVAILABLE ARE: WHITE, GRAY, BLACK, NAVY, ROYAL BLUE, SPORT BLUE, MARINE BLUE, FOREST GREEN, KELLY GREEN, LIME GREEN, BORDEAUX, MAROON, RED, FLAIR RED, PINK, BROWN, BEIGE, ORANGE, LIGHT GOLD, YELLOW, PURPLE

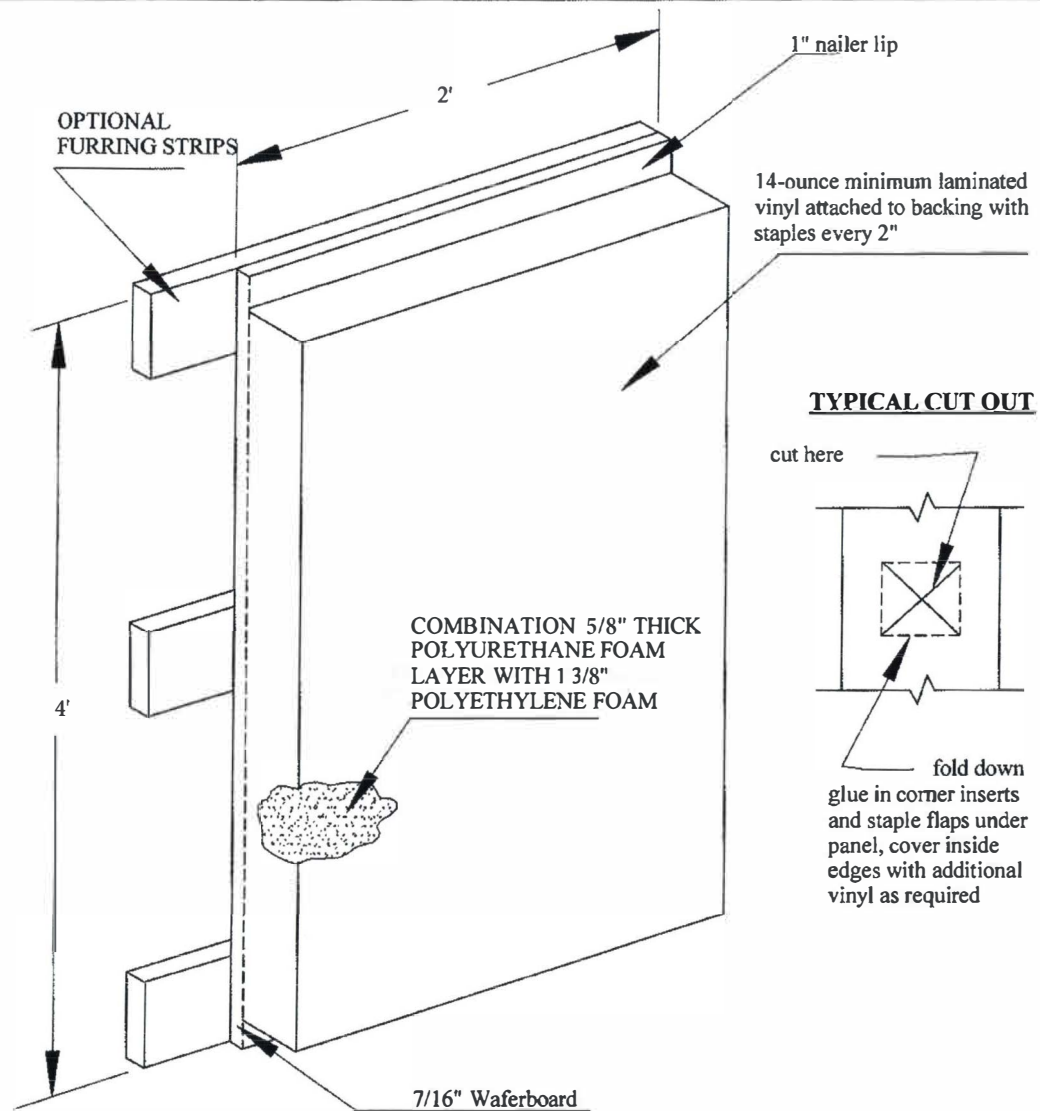

WEIGHT: 15 LBS

AMOUNT:

PACKAGED:

Date:

Approved by:

Drawn by:

A. Katz.

MODEL: WP-26LU

**AK ATHLETIC EQUIPMENT, INC.
COLUMBUS, OHIO 43213**

Drawing number: 110

MAROON AND BEIGE